

# Conveyor Technologies

Ltd. 440 Milford Parkway  
Milford, OH 45150-9104

Phone: (513) 248-0663  
Fax: (513) 248-0685  
E-mail: mail@ConveyorTechLtd.com

## AccuMove™ 17 Tooth

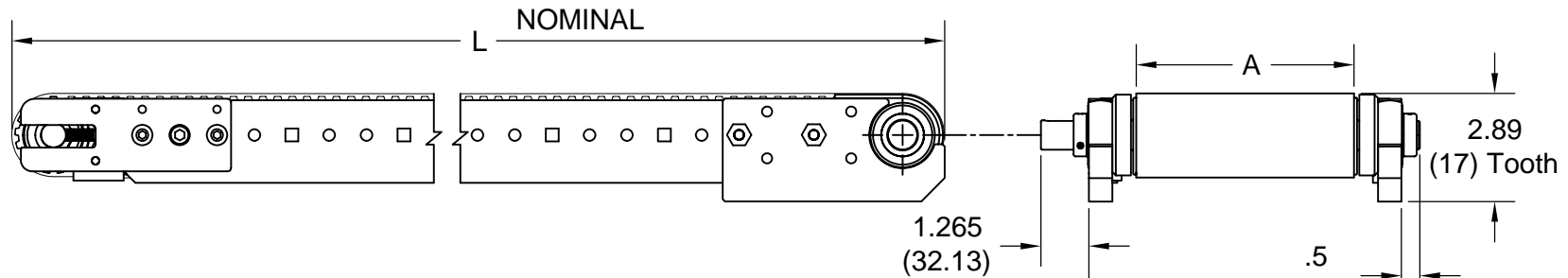

## AccuMove™ 25 Tooth

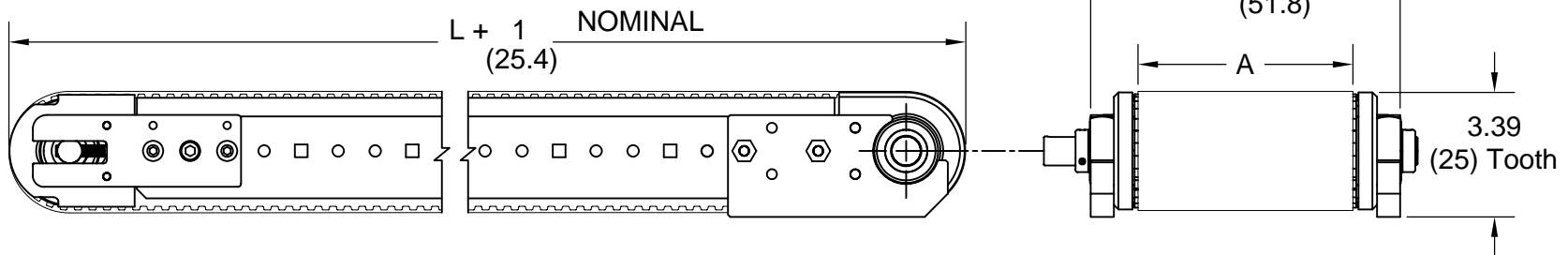

Order Width	Belt Width (A)		W
	Inches	(mm)	
02	1.97	(50)	2.5
03	2.95	(75)	3.25
04	3.94	(100)	4.5
06	5.91	(150)	6.0
07	7.40	(188)	7.5
12	11.81	(300)	12.0
18	17.72	(450)	18.0

Nominal Conveyor Length (L)	
Inches	(mm)
24"	(610)
36"	(914)
48"	(1219)
60"	(1524)
72"	(1829)
120"	(3048)

1. Drawings do not show optional dual "T" slot rails.
2. If Part Holders are supplied overall length increases.
3. Optional lengths available.